

Approximate Weight : 0.900 Kg.

Some Applications :

In non-hazardous areas for slurry, colloidal solutions, corrosive & non-corrosive working media (unclean working media), etc.

Electrical Connection :

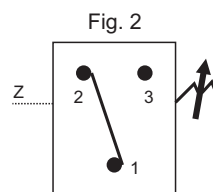



PRESSURE CAPSULE DETAILS

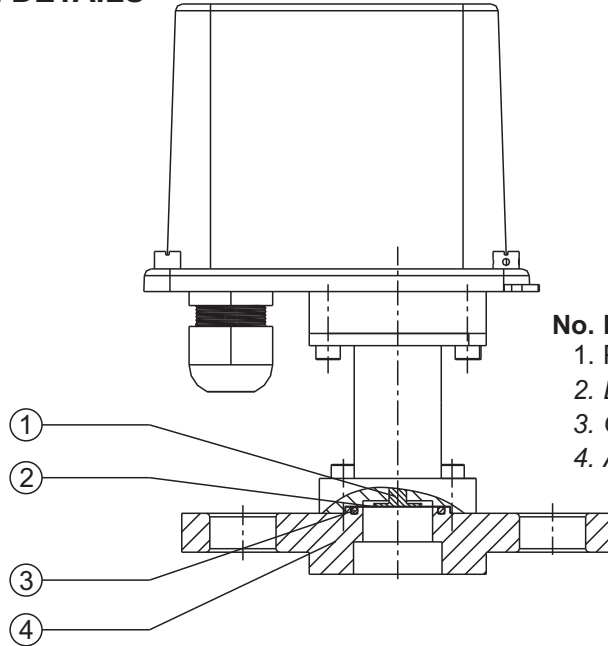

No. Description

1. Plunger
2. Diaphragm (*PTFE*)
3. O-Ring (*PTFE*)
4. ANSI 600 Flange (*SS316*)

Note : *wetted parts* are mentioned in italics.

INSTALLATION DRAWING

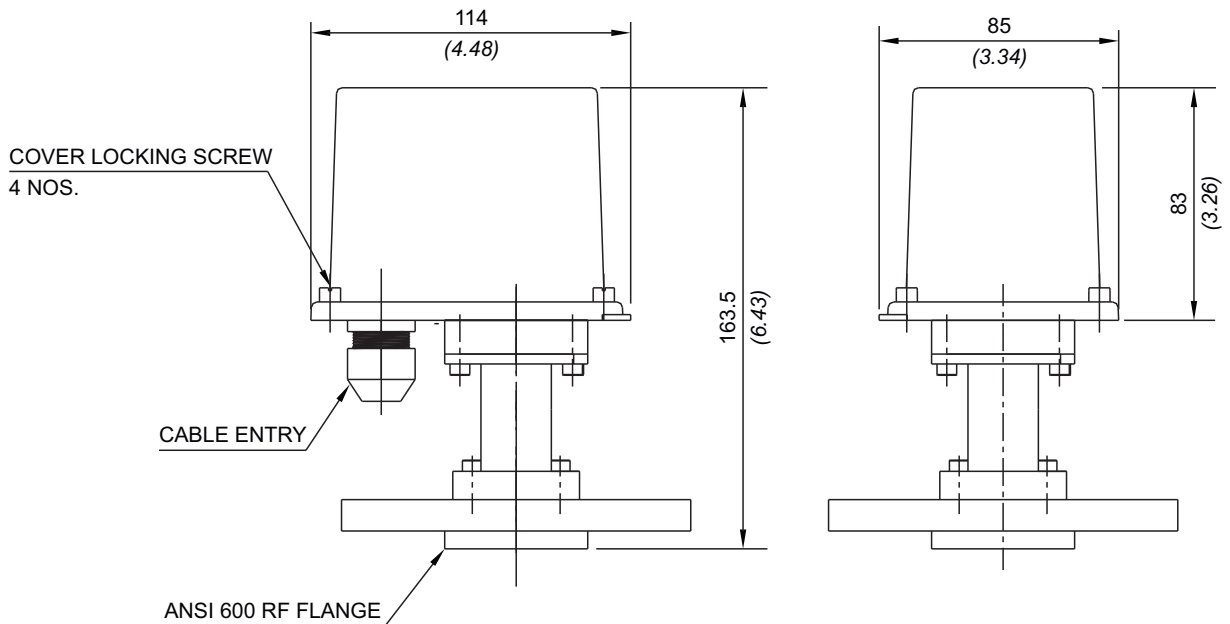

APPROX. DIMENSIONS IN $\frac{\text{mm}}{\text{inches}}$

RANGE SELECTION TABLE

Range Code	Range bar (psi)	Differential* bar (psi)	Maximum Working Pressure bar (psi)
		Approximate Maximum for "A8" microswitch	
H01	0.1 - 1.0 (1.45 - 14.50)	0.1 (1.45)	As per the class of flange Please consult Sales Office in case you need clarification on availability of maximum working pressure for a particular range.
H02	0.1 - 1.5 (1.45 - 21.76)	0.2 (2.90)	
H03	0.2 - 2.6 (2.90 - 37.71)	0.2 (2.90)	
H04	0.2 - 3.6 (2.90 - 52.21)	0.4 (5.80)	
H07	0.5 - 7.0 (7.25 - 101.50)	0.6 (8.70)	
H10	0.5 - 10.0 (7.25 - 145.04)	0.8 (11.60)	
H15	1.0 - 15.0 (14.50 - 217.71)	1.0 (14.50)	
H30	5.0 - 25.0 (72.52 - 362.6)	1.5 (21.75)	
H4T	5 - 40 (72.52 - 580.15)	5 (72.52)	
H1H	10 - 100 (145.04 - 1450.38)	12 (174.05)	
H2H	10 - 200 (145.038 - 2900.76)	24 (348.09)	
H4H	40 - 400 (580.15 - 5801.40)	70 (1015.27)	

* **Note:** Minimum differential increases with setpoint (Graphs available on request)

* Differentials of microswitches A2 through A9 will vary. Differentials for A7 are typically twice that for A1 microswitch.

Please indicate specifically the differential value in enquiry/order, when it is critical in your application.

FLANGE CODE TABLE (Please refer page no. 288 & 289 for more options)

	SS316L		Hastelloy C276		Monel		Titanium		Tantalum	
	RF*	FF*	RF*	FF*	RF*	FF*	RF*	FF*	RF*	FF*
150 #										
1" NB	AC	BS	DI	EY	GO	IE	JU	LK	NA	OQ
2" NB	AF	BV	DL	FB	GR	IH	JX	LN	ND	OT
300#										
1" NB	AI	BY	DO	FE	GU	IK	KA	LQ	NG	OW
2" NB	AL	CB	DR	FH	GX	IN	KD	LT	NJ	OZ
2500#										
1" NB	BM	DC	ES	GI	HY	JO	LE	MU	OK	QA
2" NB	BP	DF	EV	GL	IB	JR	LH	MX	ON	QD

*RF = Raised Face

*FF = Flat Face

RANGE AVAILABILITY AS PER BORE SIZES

	H01 to H04	H07	H10	H15	H30	H2T to H2H
1" NB	NA	Yes	Yes	Yes	Yes	Yes
2" NB	Yes	Yes	Yes	Yes	Yes	Yes

HOW TO ORDER PROCESS FLANGED PRESSURE SWITCHES

Group 1	Group 2	Group 3	Group 4	Group 5	Group 6	Group 7	Group 8
<p>Non standard allocation</p> <p><input type="checkbox"/> A prefix "N" is used in the model code in case of any non standard options / accessories that are provided with the switches. Will be given by manufacturer, only after agreement of supply details with customer.</p> <p>The prefix is subject to change as per specific requirement.</p>	<p>Model</p> <p>MZ = Process pressure switch with a weatherproof enclosure rated IP66/IP68 as per IS/IEC 60529</p>	<p>Cable Entry Size</p> <p>1 = Polycarbonate Enclosure 1/2" NPT threads 2 = Polycarbonate Enclosure 3/4" NPT threads 3 = Polycarbonate Enclosure M20 x 1.5 threads 4 = Diecast Al. Enclosure 1/2" NPT threads 5 = Diecast Al. Enclosure 3/4" NPT threads 6 = Diecast Al. Enclosure M20 x 1.5 threads 7 = SS Enclosure 1/2" NPT threads 8 = SS Enclosure 3/4" NPT threads 9 = SS Enclosure M20 x 1.5 threads</p> <p>Note : For dual cable entries contact sales office</p>	<p>Switch Type ANSI flanged</p> <p>AF2 = pressure switch, fixed differential with scale in bar AF3 = pressure switch, fixed differential with scale in psi *AA2 = pressure switch, adjustable differential with scale in bar *AA3 = pressure switch, fixed differential with scale in psi</p>	<p>Range Code (values in bar)</p> <p>H01 = 0.1 - 1.0 H02 = 0.1 - 1.5 H03 = 0.2 - 2.6 H04 = 0.2 - 3.6 H07 = 0.5 - 7.0 H10 = 0.5 - 10.0 H15 = 1.0 - 15.0 H30 = 5.0 - 25.0 H4T = 5 - 40.0 H1H = 10.0 - 100.0 H2H = 10.0 - 200.0 H4H = 40.0 - 400.0</p>	<p>Microswitch Type</p> <p>A8 = General purpose microswitch A7 = 2SPDT microswitches A9 = General purpose microswitch</p> <p>* Please refer to page nos. 290 & 291 for options and specifications of microswitches Please contact sales office for additional information</p>	<p>Flange Size and Material</p> <p>Please refer to the flange code table on Page nos. 288 & 289 for selection of the flange</p>	<p>Diaphragm</p> <p>0 = Neoprene 1 = Teflon 2 = SS316L 3 = Hastelloy C 4 = Monel 400 5 = Titanium 6 = Tantalum</p>

eg. A high range process ANSI flanged pressure switch with 1/2" NPT cable entry with fixed differential without scale, having 0.1 bar to 1 bar pressure range, with 15 Amp. microswitch, and 2" 150# RF SS316L flange & SS316L diaphragm shall be specified by

Group 1	Group 2	Group 3	Group 4	Group 5	Group 6	Group 7	Group 8
<input type="checkbox"/>	MZ	3	AF2	H01	A8	AF	2

Please specify full model number to avoid ambiguity.